

### LEGEND

- MAJOR ARTERIAL (100' ROW)
- FUTURE MAJOR ARTERIAL
- MINOR ARTERIAL (85'/90' ROW)
- FUTURE MINOR ARTERIAL
- MAJOR COLLECTOR (66' ROW)
- FUTURE MAJOR COLLECTOR
- MINOR COLLECTOR (60' ROW)
- FUTURE MINOR COLLECTOR
- RESIDENTIAL COLLECTOR (55' ROW)
- FUTURE RESIDENTIAL COLLECTOR
- RESIDENTIAL STANDARD (50' ROW)
- FUTURE RESIDENTIAL STANDARD

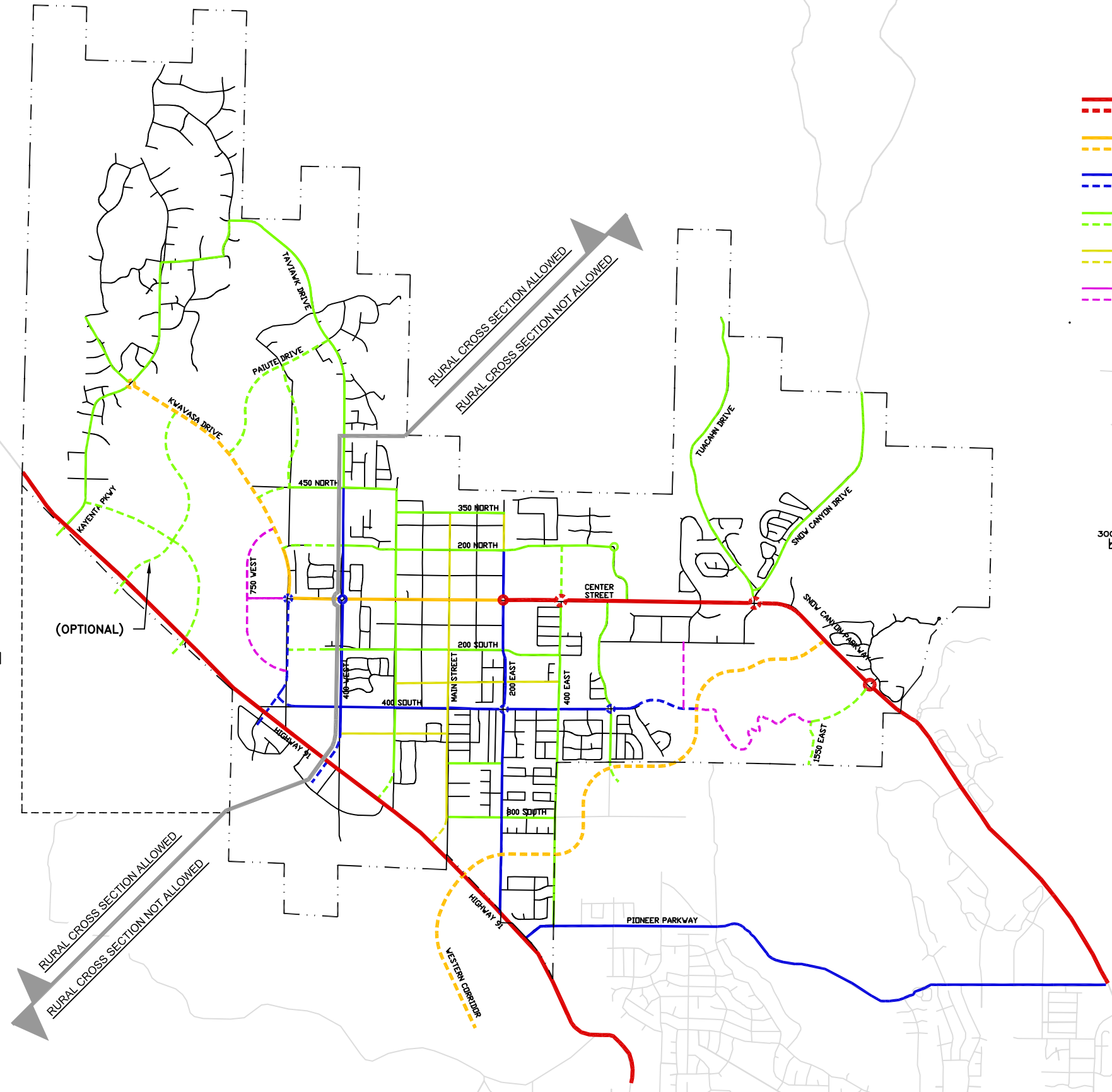
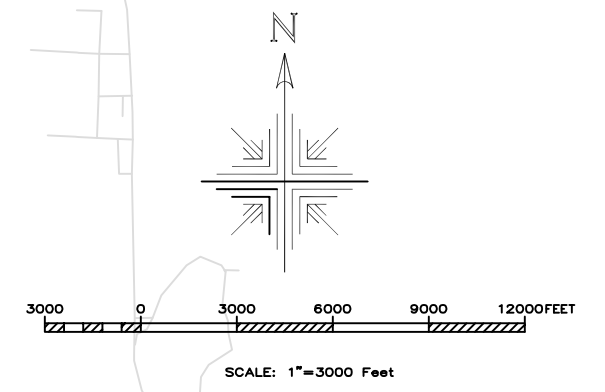

### NOTE

1. THE PORTION OF KWAVASA DRIVE SHOWN AS A FUTURE ARTERIAL ROAD, RESERVE 80' R/W CORRIDOR BUT CONSTRUCT AS MAJOR COLLECTOR ROAD UNTIL TRAFFIC INCREASES TO BEYOND ACCEPTABLE SERVICE LIMITS.
2. ALL FUTURE ROADS ARE SHOWN CONCEPTUALLY FOR THE PURPOSE OF INDICATING REQUIRED CONNECTIVITY. ACTUAL ALIGNMENT OF FUTURE ROADS MAY BE ADJUSTED IN THE DETAILED DESIGN OF THE SUBDIVISIONS AND SITE DEVELOPMENTS AS DETERMINED TO BE APPROPRIATE AS LONG AS CONNECTIVITY PURPOSES ARE SATISFIED.

SCALE  
1"=3000'

DATE  
Dec. 22, 2008

**HORROCKS ENGINEERS**

285 WEST TABERNACLE  
SUITE 300  
ST. GEORGE, UT 84770  
(435) 986-7888



**Ivins TMP Update**  
FUNCTIONAL CLASSIFICATION &  
CROSS-SECTION

FIGURE NO.  
**9**